

## How to tighten the screws

1. It is always recommended to tighten the screws deep enough. The tighter the screws are, the more stable a puzzle will be (and probably more stiff while making turns).

2. Always leave a little bit of radial space along the screw so that the center cap can be lifted by around 1~2mm for single layered models.

**\*\*For those in-between models, like #65, #85, #88, #89, it is recommended to tighten further.**

**\*\*For neat multiple layered models like #61, #75, #87, tighten the screws to their full depth.**

3. Rules of thumb. Tension adjustment is in general dependent on personal judgement. Different tension could result in very different feel. Start with simple models and accumulate your own sense. Use different springs, screws, nuts if you think the default set can't provide your favorite handle.

4. Previous description of sticking screws out of nuts by 1-3mm is misleading in some cases and is not anymore recommended. Reason: the height of caps varies in different models.

VeryPuzzle  
2021/08/06

# VeryPuzzle



**Megaminx Ball V1.0 - C1**

**D5-C1**

**#60**

300+ parts  
12 axes



1

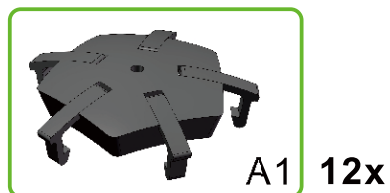
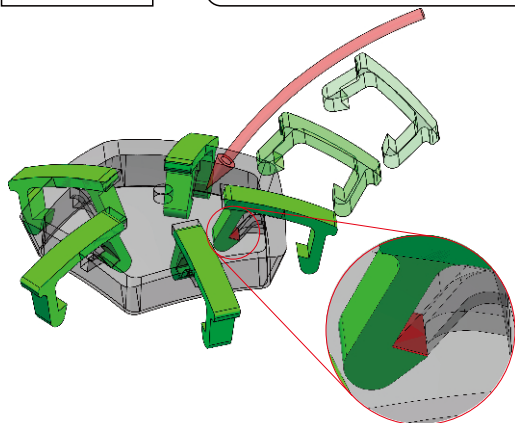

2

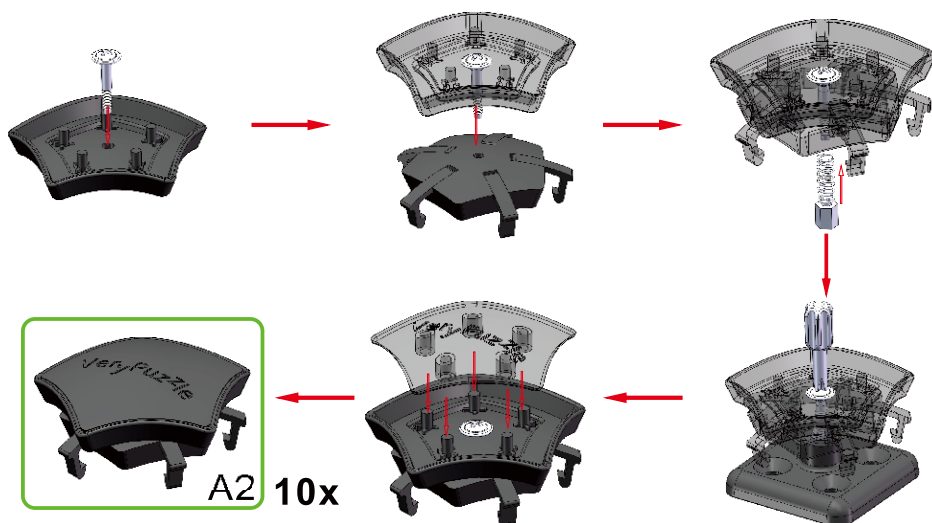
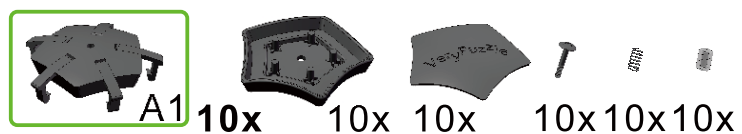

3

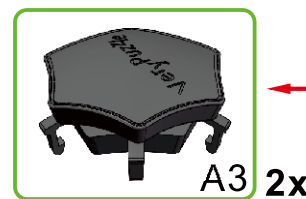
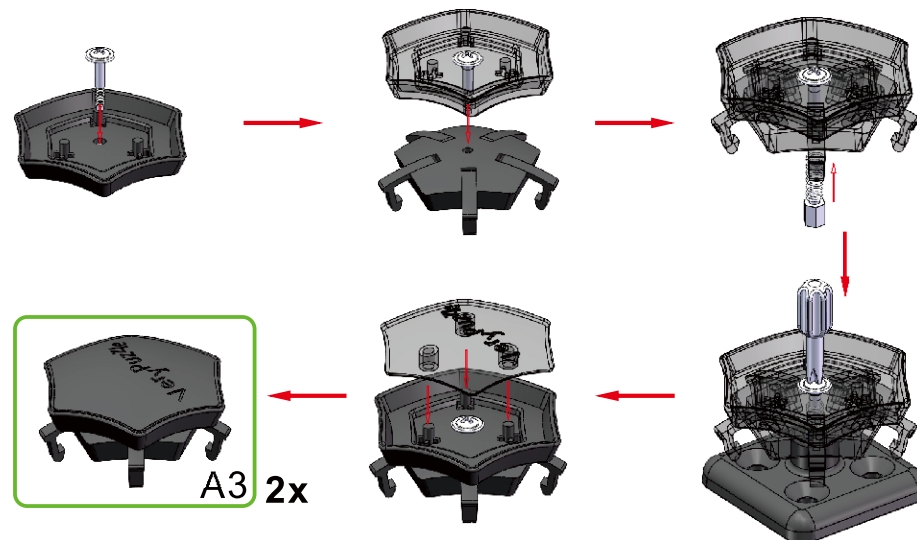
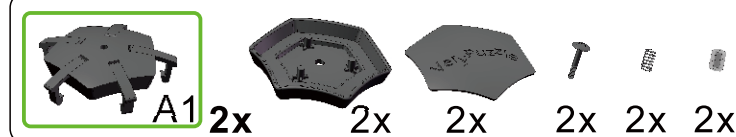

4

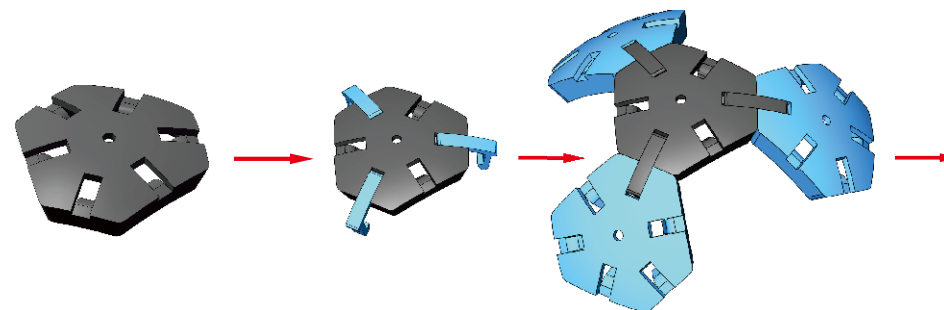
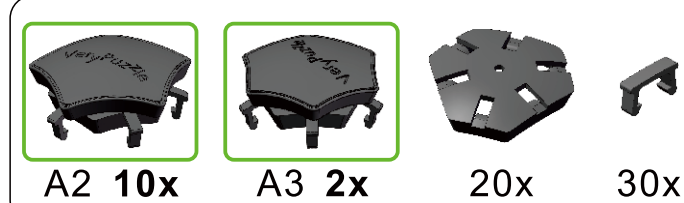

4

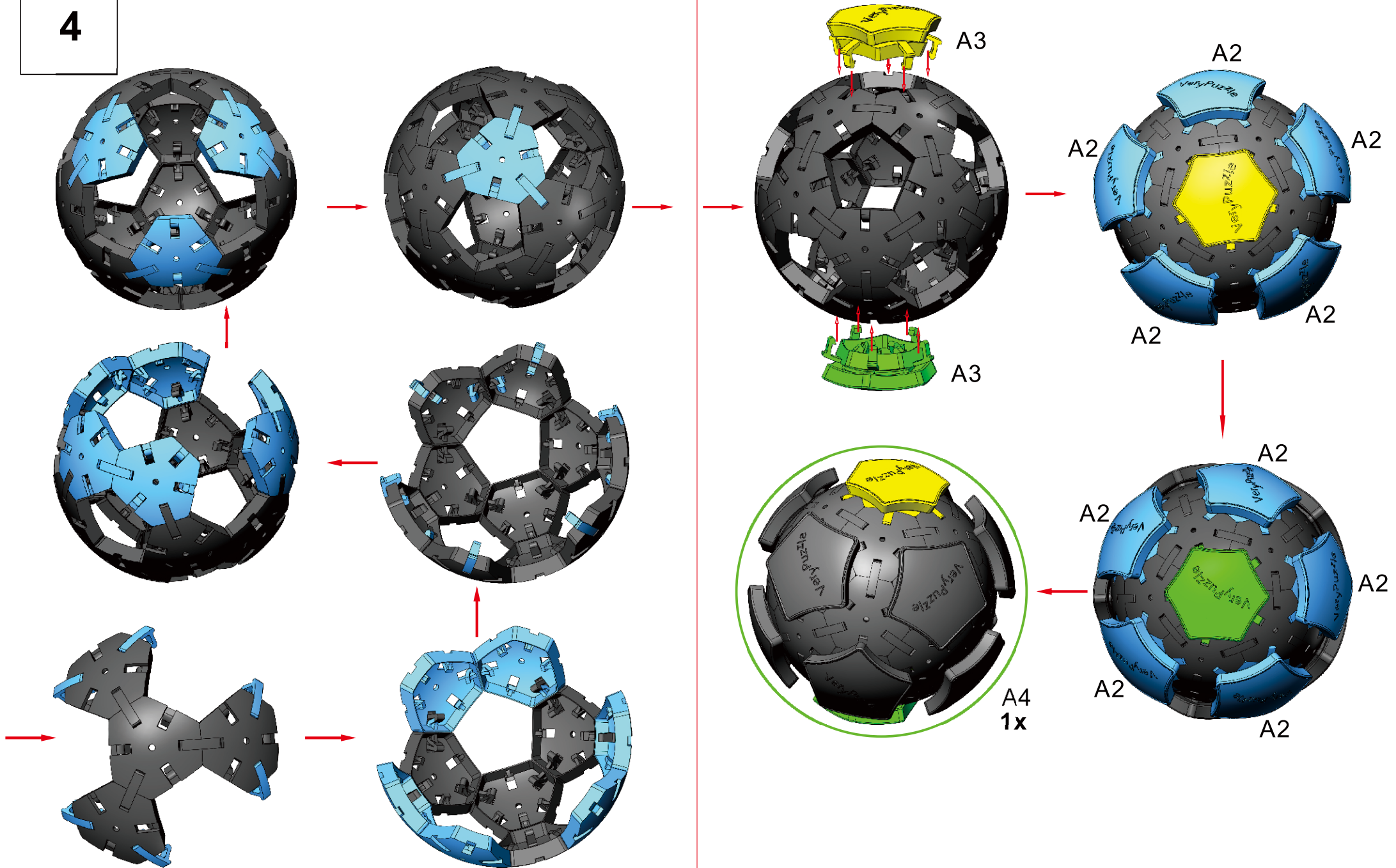



5

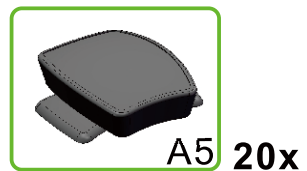
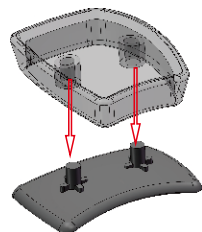
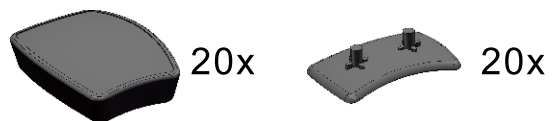

6

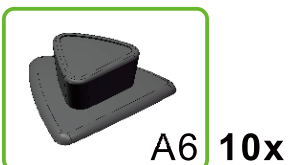
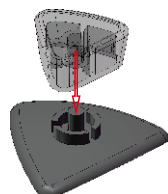

7

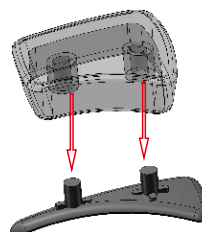

8

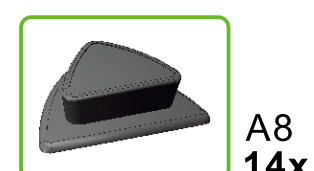
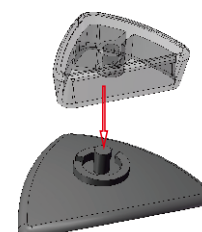

9

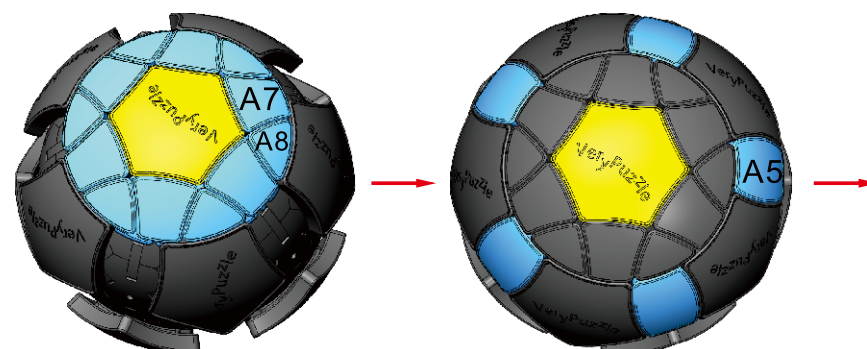
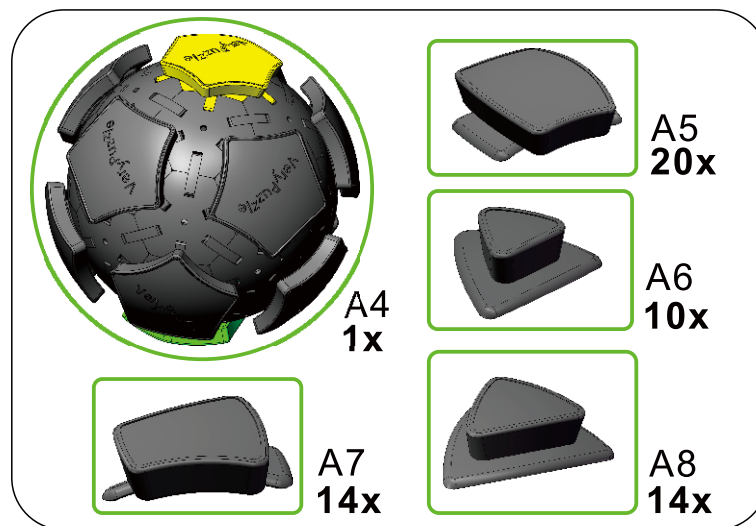



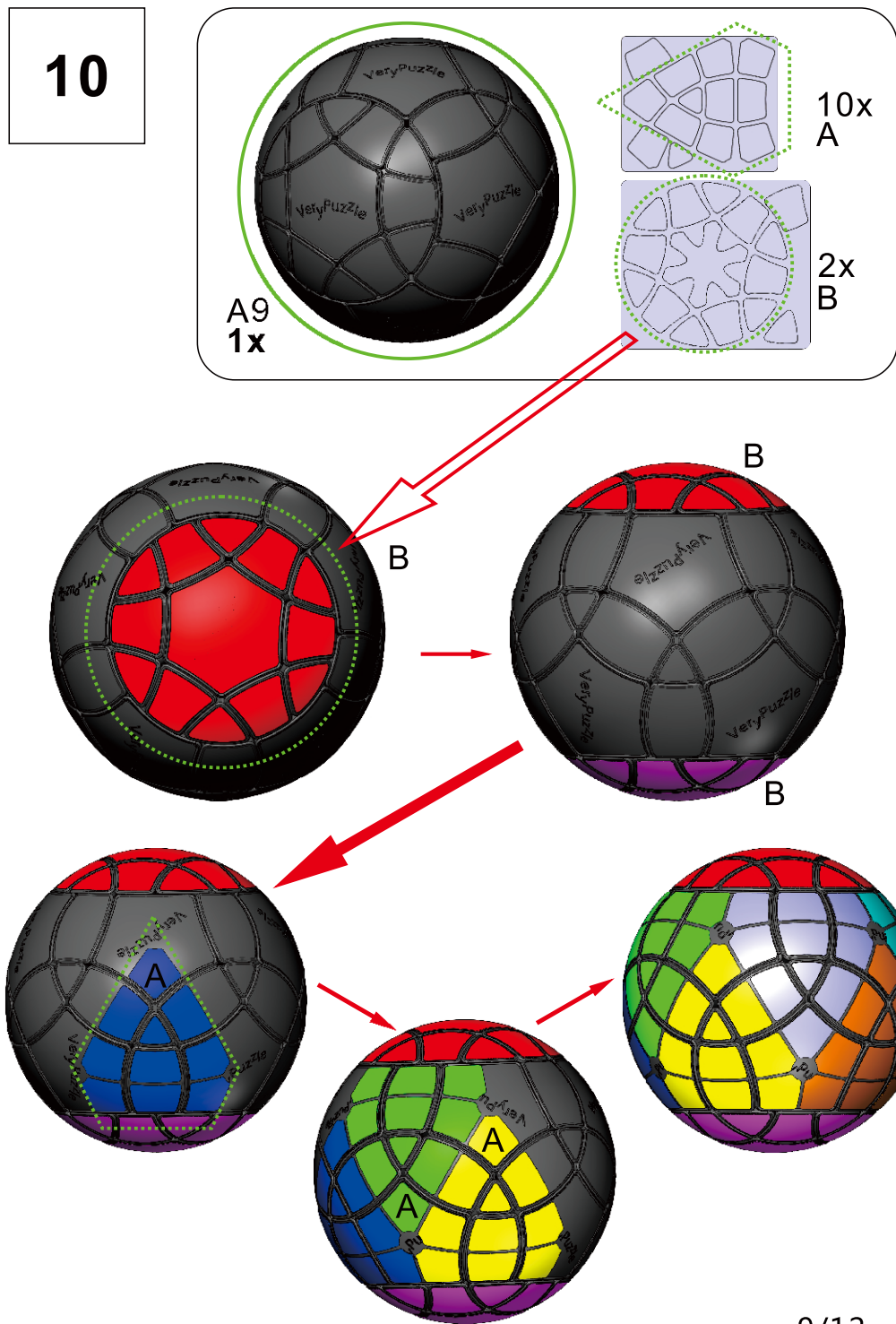
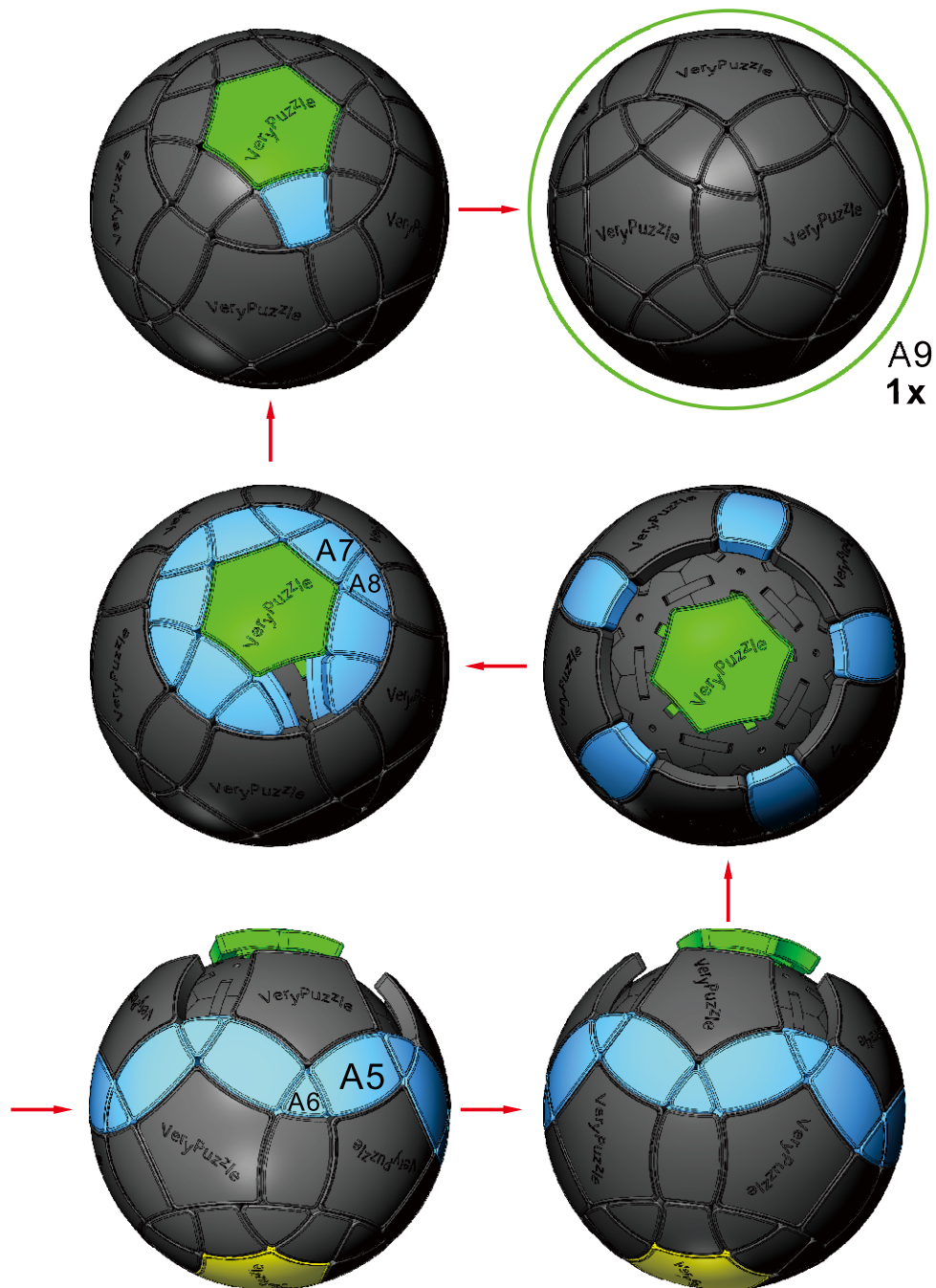

11

## Rotation Rules



6-fold symmetry,  
turns  $60 \cdot n$  degrees



5-fold symmetry when aligned,  
turns  $72 \cdot n$  degrees

## Notations and Algorithms



## Product Information Card

<b>Product Name</b>	Megaminx Ball V1.0 - C1
<b>Model NO.</b>	#60
<b>Design</b>	VeryPuzzle Co., Ltd(HK)
<b>Manufacturer</b>	VeryPuzzle Co., Ltd(HK)
<b>Date of release</b>	2020/08/12
<b>Maximum diameter</b>	95 mm
<b>Visible moving parts</b>	70 pcs
<b>Assembly challenge</b>	★★★☆☆☆☆☆☆
<b>Solving challenge</b>	★★★★☆☆☆☆☆☆
<b>Sticker strategy</b>	Voronoi, partial
<b>Sticker material</b>	Uniform, Matt
<b>Color scheme</b>	12 colors
<b>Sticker protection</b>	Yes
<b>Number of stickers</b>	130 pcs
<b>Axis &amp; Symmetry</b>	$D \setminus \{P1, P2\}(C5)$ , $P1 \& P2(C6)$
<b>In-core spring</b>	Yes
<b>Adjustable tension</b>	No
<b>Topological Print</b>	D49
<b>Core specification</b>	DI80

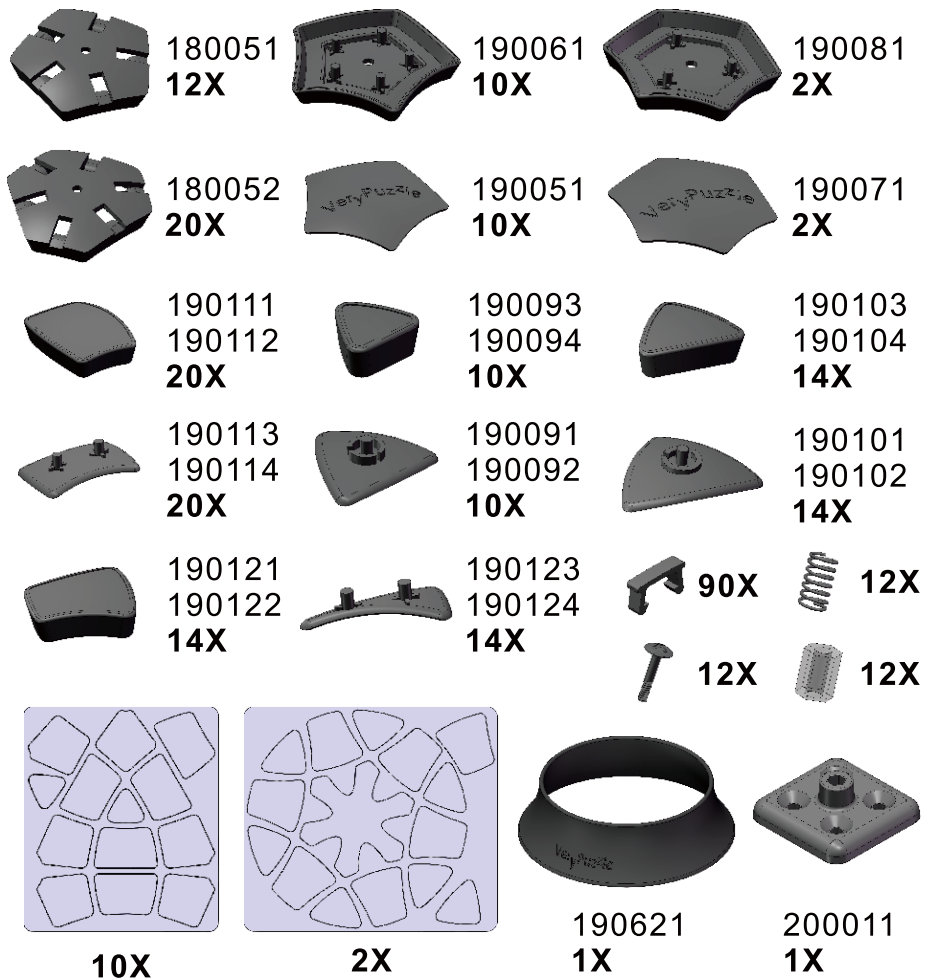

## Customer Service

1. [support@verypuzzle.com](mailto:support@verypuzzle.com)

2.



VeryPuzzle